

HUNTERS[®]

HERE TO GET *you* THERE



Flat 8 Hemsley House

2 Bettenson Close, Chislehurst, BR7 5FG

£1,650 Per Month



Floor Plan

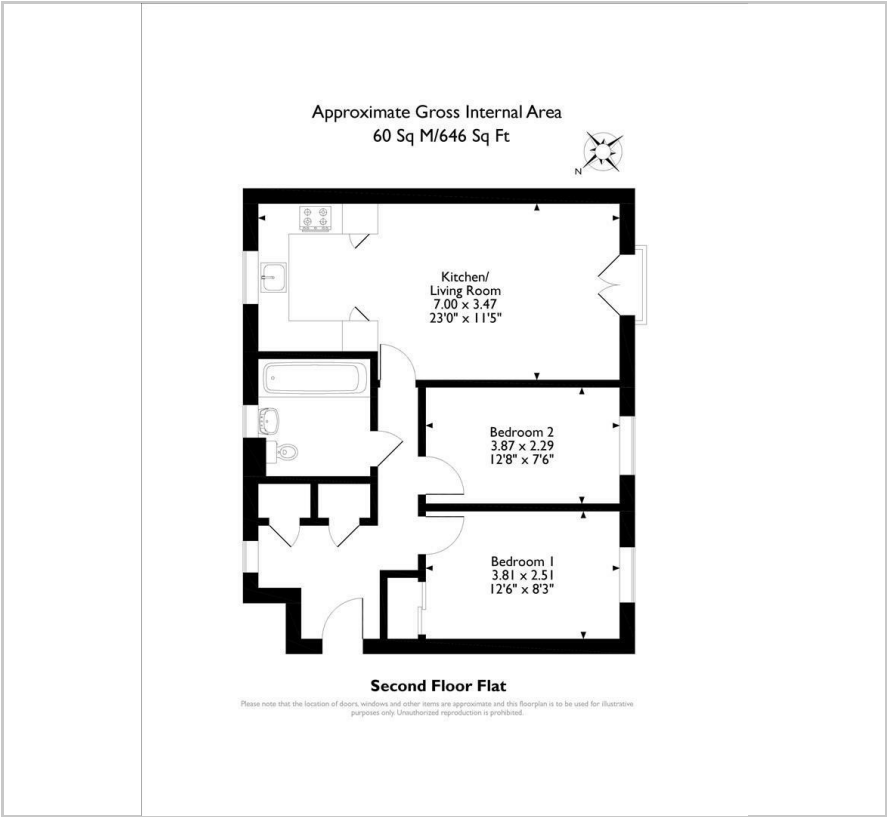

Area Map



Energy Efficiency Graph

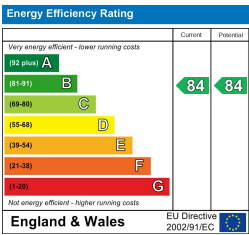

Viewing

Please contact our Hunters Bromley & Chislehurst Lettings Office on 020 8464 2555 if you wish to arrange a viewing appointment for this property or require further information.

- TOP FLOOR FLAT
- KITCHEN/LIVING ROOM
- ALLOCATED PARKING
- HIGH STREET 0.5 MILES
- TWO BEDROOMS
- FITTED KITCHEN
- OVERLOOKING GREEN
- LOW ENERGY RATING



Hunters are delighted to offer for rental this unfurnished spacious modern built two bedroom top floor apartment situated in the King's Quarter development overlooking the green and stunning distant views of the Kent skyline. The property was built circa 2013 and is located 0.5 miles from both Elmstead Woods railway station and Chislehurst high street with its shops, bars, restaurants, commons and pond.

To the ground floor there's a communal entrance with stairs leading to the second floor. The accommodation comprises of entrance leading to a spacious lobby area with two storage cupboards housing boiler and heating system and a further hallway leading to all rooms. The kitchen/ living room is dual aspect and has a Juliet balcony overlooking the green to the front. The modern fitted kitchen has fitted units to include fridge/ freezer, plumbing for washing machine, oven and ceramic hob with extractor hood over. There are two bedrooms and a large family white suite bathroom. Bedroom one has a built-in wardrobe. The property benefits from having an intercom entry system, double glazing and gas central heating. Outside there is a communal garden, the property has allocated parking for one car and there is also visitors parking. EPC Band B.



These particulars are intended to give a fair and reliable description of the property but no responsibility for any inaccuracy or error can be accepted and do not constitute an offer or contract. We have not tested any services or appliances (including central heating if fitted) referred to in these particulars and the purchasers are advised to satisfy themselves as to the working order and condition. If a property is unoccupied at any time there may be reconnection charges for any switched off/disconnected or drained services or appliances - All measurements are approximate. **THINKING OF SELLING?** If you are thinking of selling your home or just curious to discover the value of your property, Hunters would be pleased to provide free, no obligation sales and marketing advice. Even if your home is outside the area covered by our local offices we can arrange a Market Appraisal through our national network of Hunters estate agents.